

Model No. HPM-**-***

Pressure sensors produced using the latest semiconductor process and micromachining technologies offer high sensitivity and High precision, meeting all user needs. Furthermore, we can flexibly accommodate custom products tailored to specific

■Features

- Analog output

High precision and stability achieved through various digital corrections performed by built-in EEPROM

- Low current consumption: 2mA Max.
- Discrete type, flange-mounted connector type

■Dimensions

Discrete Type: HPM-**-B**

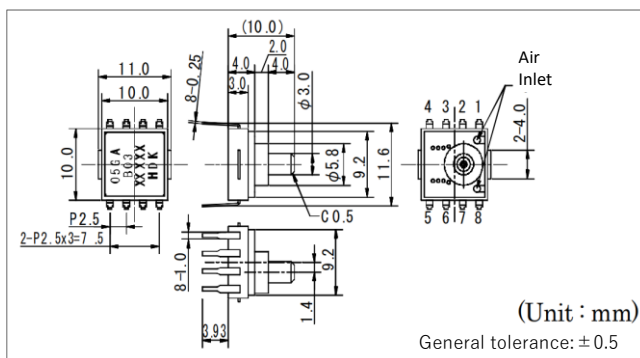

Flange Mounting Connector Type: HPM-**-D**

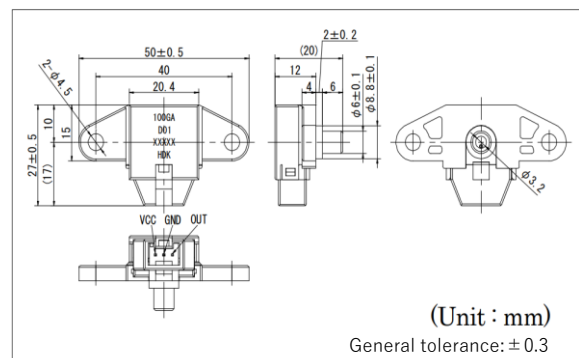

■Basic Specifications

Item	Rated		Unit
	HPM - ** - B **	HPM - ** - D **	
Model	HPM - ** - B **	HPM - ** - D **	
Shape	Discrete Type	Flange Mount Connector Type	
Output Form	DC		
Absolute Maximum Rated			
Output Form	Gauge Pressure		
Pressure Medium	Water, air, other non-corrosive media		
Maximum Applied Pressure	2 times Rated value		kPa
Storage Temperature Range	-40~85		°C
Accuracy Guaranteed Temp	-10~60		°C
Power supply voltage	5	5 or 12	V
Conditions and Electrical Characteristics			
Pressure Range	-90 to 1000 (Customizable within the specified pressure range)		kPa
Output	0.5 to 4.5 (Basic Range)		V
Output Accuracy	±2		%FS
Pressure linearity	±0.5		%FS
Pressure Hysteresis	±0.3		%FS
Current Consumption	2.0 Max		mA

*Custom specifications (various pressure ranges, etc.) are available based on the above basic specifications.

■Model Number Structure

HPM - ** G A - B **

① ② ③ ④ ⑤ ⑥

①: Pressure Sensor Module "HPM"

②: Pressure Full-Scale Span

③: Pressure Type "G: Gauge Pressure"

④: Analog Output

⑤: Form Factor

(B: Discrete Type, D: Flange Mount Connector Type)

⑥: Custom Part Number